



# IN LINE CENTRIFUGAL DUCT FANS **TURBO**





# IN LINE CENTRIFUGAL DUCT FANS TURBO

Range of centrifugal high performances fans to convey in ducts air or fumes with a maximum temperature of 55°C.

Suitable for applications in domestic, commercial and industrial such as bathrooms, kitchens, offices, factories, shops, bars, gymnasiums, restaurants etc...

- Complete range of inlet and outlet diameters to allow the installations in most standard sizes of commercial ducts.

- The range is composed by 14 models either in standard version with high performances then in ES version that offers a good noise level and a reduction in energy consumption increasing the life of the products.

- All the models mount ball bearing motors with thermoprotector.

- Zinc plated steel body, high resistance motor support with incorporated airflow fins.

- Mounting bracket integrated with the product that allows installation in any position. Holes provided in the bracket allow mounting with cords.

- Installation and electric connection particularly fast and easy.

- Electric boxes with IP54 protection.

- Product protection IPX4.

- Double insulated product, electric grounding is not necessary.

- Motor speed can be regulated with an optional electronic regulator (see page 87).

- In accordance with EN 60335-2-80.

Accessories:

- See page 87.

## Dimensions

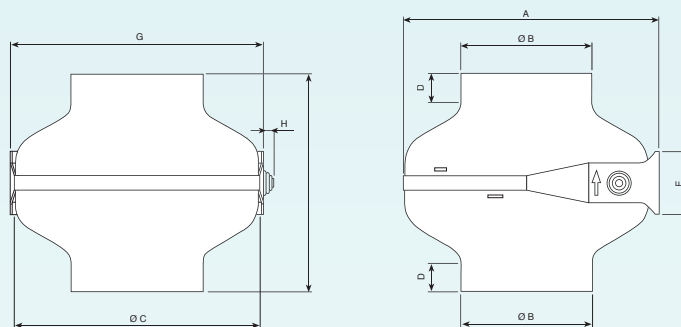

Model	A	Ø B	Ø C	D	E	F	G	H	Kg
<b>Turbo 100 ES</b>	287	98	275	17	70	242	282	12	3
<b>Turbo 100</b>	287	98	275	17	70	242	282	12	3
<b>Turbo 125 ES</b>	287	123	275	24	70	242	282	12	3
<b>Turbo 125</b>	287	123	275	24	70	242	282	12	3
<b>Turbo 150 ES</b>	287	148	275	32	70	242	282	12	3
<b>Turbo 150</b>	287	148	275	32	70	242	282	12	3
<b>Turbo 160 ES</b>	287	158	275	35	70	242	282	12	3
<b>Turbo 160</b>	354	158	345	24	84	272	345	12	5,5
<b>Turbo 200 ES</b>	354	198	345	34	84	272	345	12	4
<b>Turbo 200</b>	354	198	345	34	84	272	345	12	5,5
<b>Turbo 250 ES</b>	354	248	345	48	84	272	345	12	4
<b>Turbo 250</b>	354	248	345	48	84	272	345	12	5,5
<b>Turbo 315 ES</b>	354	313	345	48	84	272	345	12	5,5
<b>Turbo 315</b>	354	313	345	48	84	272	345	12	6

## Technical Data

Model	Ref.	Flow rate m³/h	Max Press. mm. H <sub>2</sub> O	W	230 V Hz	dB(A) 3m (*)	Nom. Curr. in A. at 230V	RPM
<b>Turbo 100 ES</b>	OW 371 7	210	30	55	50	45	0.25	2000
<b>Turbo 100</b>	OW 370 9	270	30	75	50	53	0.35	2600
<b>Turbo 125 ES</b>	OW 374 1	290	29	55	50	45	0.25	1850
<b>Turbo 125</b>	OW 373 3	400	29	75	50	52	0.38	2530
<b>Turbo 150 ES</b>	OW 377 4	370	27	55	50	42	0.25	1850
<b>Turbo 150</b>	OW 376 6	500	29	75	50	52	0.38	2530
<b>Turbo 160 ES</b>	OW 378 2	540	28	75	50	52	0.38	2500
<b>Turbo 160</b>	OW 379 0	710	37	90	50/60	56	0.43	2500
<b>Turbo 200 ES</b>	OW 380 8	730	30	90	50/60	56	0.42	2550
<b>Turbo 200</b>	OW 381 6	1050	55	180	50/60	58	0.78	2550
<b>Turbo 250 ES</b>	OW 382 4	800	32	90	50/60	58	0.40	2550
<b>Turbo 250</b>	OW 383 2	1200	56	180	50/60	59	0.78	2590
<b>Turbo 315 ES</b>	OW 385 7	1250	50	180	50/60	59	0.78	2600
<b>Turbo 315</b>	OW 384 0	1400	65	280	50/60	59	1.24	2500

\* dB (A) at 3 meters with ducted inlet and outlet.



# IN LINE CENTRIFUGAL DUCT FANS TURBO

## Application / Installation

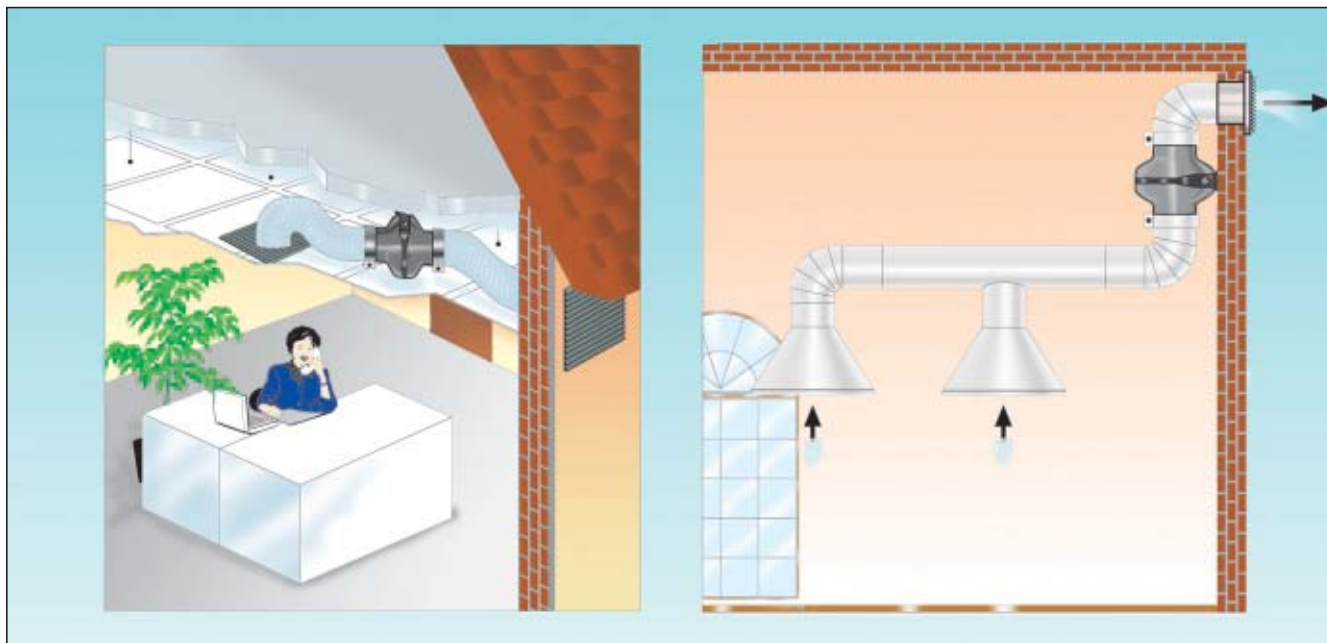

## Aeraulic performances

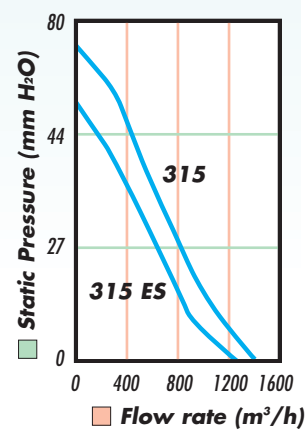
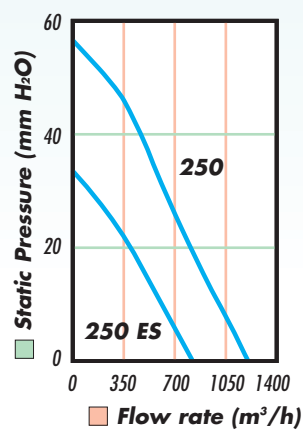
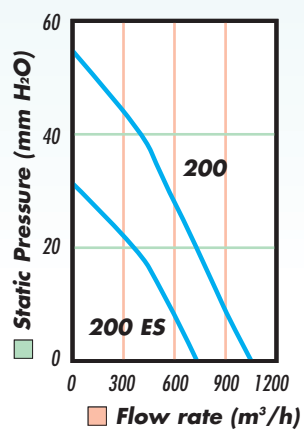
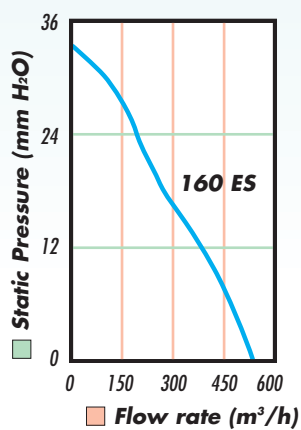
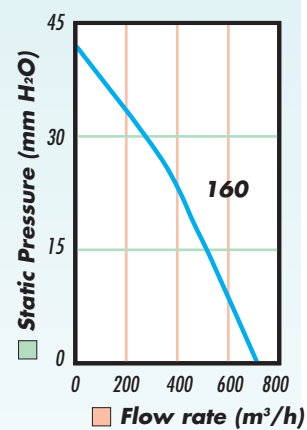
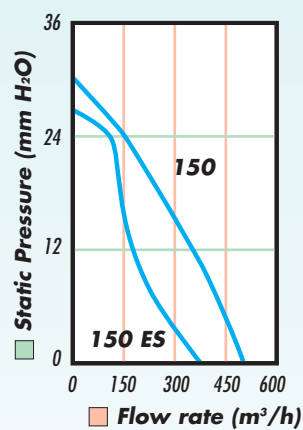
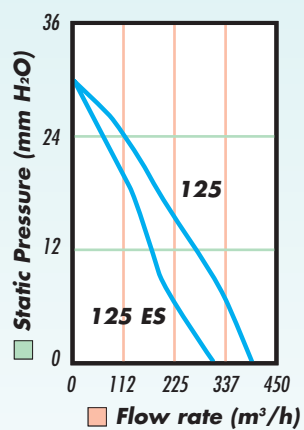
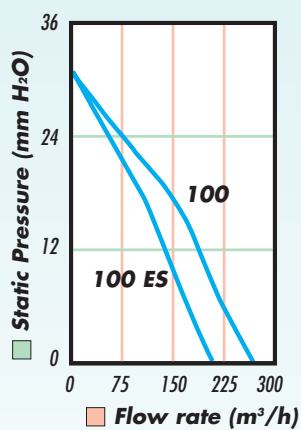



# ACCESSORIES - INDUSTRIAL SERIES -

## Protection grille

Safety protection grille to protect appliance from any accidental contact. Made of in zinc plated steel. Fixing screws included.

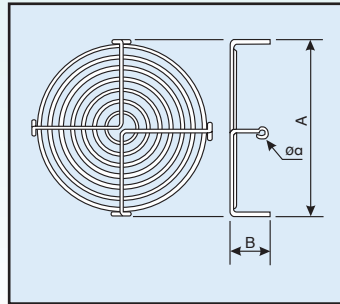
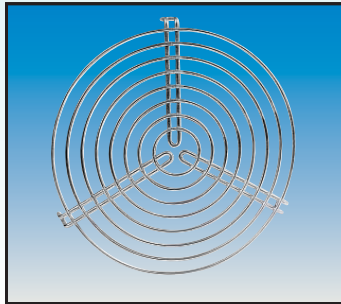

Model	Ref.	ø A	B	ø a
<b>TST/TURBO 100</b>	OW 608 2	100	20	4,5
<b>TST/TURBO 125</b>	OW 609 0	125	20	4,5
<b>TST/AC/TURBO 150</b>	OW 610 8	150	20	4,5
<b>TURBO 160</b>	OW 629 8	160	20	4,5
<b>TST/AC/TURBO 200</b>	OW 611 6	200	20	4,5
<b>TST/TURBO 250</b>	OW 612 4	250	20	4,5
<b>TST/TURBO 315</b>	OW 613 2	315	20	4,5

## Backdraught shutter

Shutters open automatically with air flow. Zinc plated body. Aluminum shutters.

Model	Ref.	A	ø B
<b>TST/TURBO/TURBO PLAST 100</b>	OW 622 3	77	94
<b>TST/TURBO/TURBO PLAST 125</b>	OW 623 1	90	119
<b>TST/AC/TURBO//TURBO PLAST 150</b>	OW 624 9	102	144
<b>TURBO/TURBO PLAST 160</b>	OW 621 5	100	156
<b>TST/AC/TURBO 200</b>	OW 625 6	127	194
<b>TST/TURBO250</b>	OW 626 4	152	244
<b>TST/TURBO 315</b>	OW 627 2	185	309

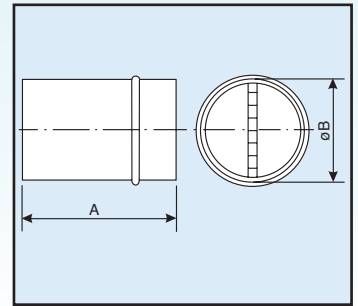
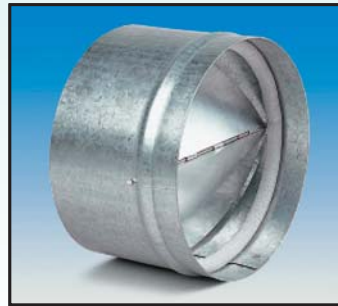

## Duct clamp

Made of zinc plated steel. Neoprene rubber gasket.

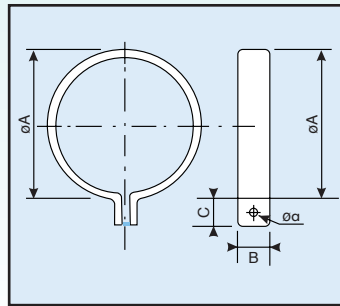

Model	Ref.	ø A	B	C	ø a
<b>TST/TURBO/TURBO PLAST 100</b>	OW 614 0	105	40	20	7
<b>TST/TURBO/TURBO PLAST 125</b>	OW 615 7	130	40	20	7
<b>TST/AC/TURBO//TURBO PLAST 150</b>	OW 616 5	155	40	20	7
<b>TURBO/TURBO PLAST 160</b>	OW 620 7	165	40	20	7
<b>TST/AC/TURBO 200</b>	OW 617 3	205	40	20	7
<b>TST/TURBO 250</b>	OW 618 1	255	40	20	7
<b>TST/TURBO 315</b>	OW 619 9	320	40	20	7

## Industrial Regulator RGM 2

This electronic regulator is suitable for industrial environments and in compliance with the Machine Directive. It allows a continuous speed regulator protection IP55.

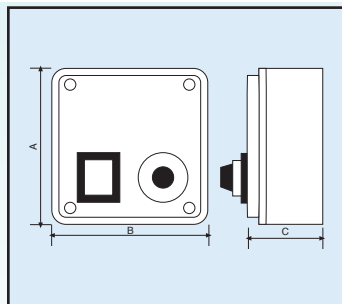

Model	Ref.	A	B	C	Weight Kg	A max
<b>RGM 2</b>	OW 300 6	108	108	100	0,2	1,6 A

## Domestic Regulator RG E

This electronic regulator is suitable for domestic environments. It can control single phase fans up to 300W.

It can be recessed through a dedicated accessory COD OW 905 2.

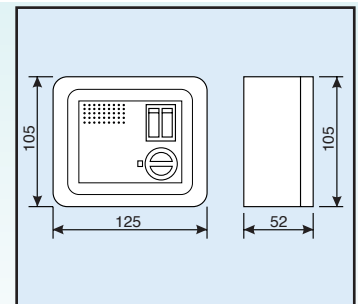

Model	Ref.
<b>RG E</b>	OW 317 0